

FUZZY SYMMETRY

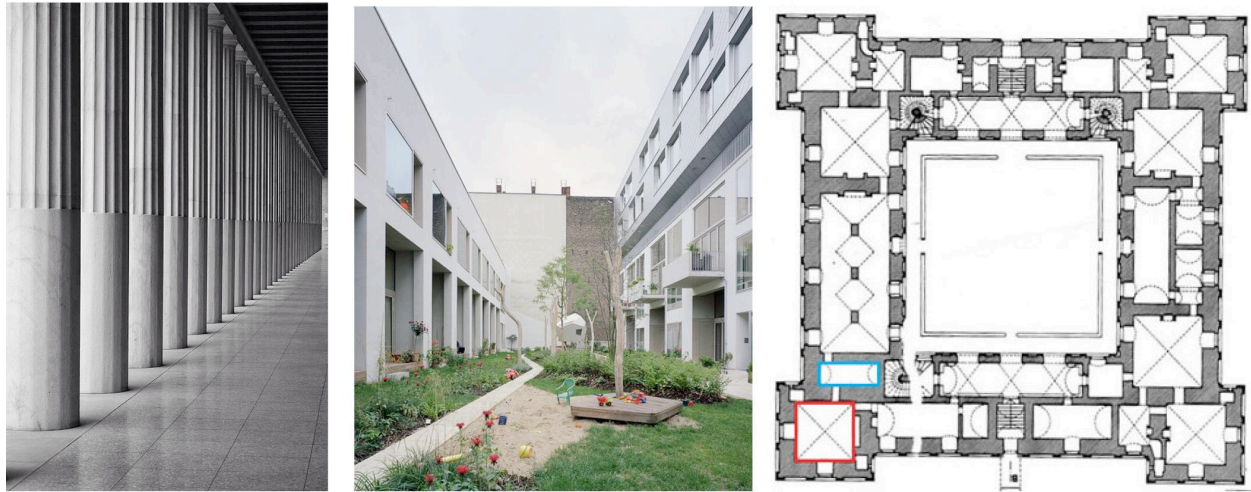

INTRODUCTION

This is one studio, in a series of studios, which looks closely at shifts in the way that individuals live; students studying these shifts will innovate a new model for living. At this moment in time, New York City is undergoing many crises, which residents experience on a daily basis. Most of the reasons for the crises are not visible - the reasons are sometimes cloaked in legal and political verbiage obfuscating clarity and responsibility, literally buried beneath the Earth's surface, or worse, consciously ignored.

This studio will collectively examine two issues New York City is facing – an affordable housing shortage, and fatigued water management systems. To respond to these current conditions, the studio will design a housing project which simultaneously pushes back on existing models of living and outdated water management systems (i.e. drinking water, wastewater, stormwater, and/or coastal resiliency). The pedagogical focus of this studio will invite students to question through architectural production the role of symmetry (or lack thereof) between the aforementioned reasons for New York City's crises. How is what is above ground in relation to what is below ground? Does public policy serve inhabitants needs, or not? We will collectively theorize the *role of symmetry*, and of course its many cousins: asymmetry, bilateral symmetry, translational symmetry, rotational symmetry, axial symmetry, among others.

The studio will design on a seemingly symmetrical site on Roosevelt Island - located between parks to the north and south, and bordered by the East River to the east and west. The topic of symmetry has been situated and advocated in historical texts as a fundamental characteristic of beauty and economical design. The studio will question these fundamentals, and recast symmetry as something that might not be only spatially or physical derived, but also a concept that is implied, unseen, and experienced through architecture. By doubting the historical legacy of symmetry, defined as “the relation between identical parts on opposite sides of an axis,”¹ the studio aims to activate a new conception of the part to whole relations.

¹ Antoine-Christophe Quatremère de Quincy, *Dictionnaire*, I, “Symétrie,” p.510

Studio Statement, Daisy Ames

APPROACH

The main questions the studio will ask are:

1. In what ways can a new model of living be extracted and innovated from Mayor de Blasio's New York City Housing Plan 2.0?
2. In what way can projects on this small site transform the waterfront of Roosevelt Island and neighboring territories, by expanding on Mayor de Blasio's New York City Ferry service?
3. In what way can symmetry become a useful tool to analyze and redraw the existing conditions?
4. What are novel ways with which the term symmetry can be used as a design tool and represented through new drawing methods today?

The studio aims for clearly articulated, intellectually rigorous, housing projects which put forth a radical model for living on Roosevelt Island in the future. It is highly suggested that students work in pairs of two.

STUDIO CULTURE

The studio is conducted on Monday, Wednesday and Thursdays from 2:00 pm – to 6:00 pm in Avery. Attendance at each studio session is required and thoughtful communication is necessary when running late. If a student shall be ill or miss a course, an email is required to the instructor in advance. Deadlines are clearly indicated on the schedule and those are inflexible. Of utmost importance is a clearly communicated concept which is supplemented by a complete set of drawings. Studio readings will be followed by studio discussions as it relates to our program and conceptual investigation. Weekly pinups and desk crits will be the method of presenting and receiving feedback from your studio critic and guest critics.

GRADING

Grading will be based on each individual student's attendance, studio participation, respectful discourse, progress, and completion of each of the exercises. Student evaluation will be based on student's commitment, self-evaluation, development of the concept, design skills, verbal communication, graphic representation and application of technologies. The potential grades are as follows: High Pass (HP), Pass (P), Low Pass (LP) and Fail (F). The studio culture strives for each student's goals to be clearly verballing communicated and graphically represented.

Studio Statement, Daisy Ames

SCHEDULE

	MONDAY	WEDNESDAY	THURSDAY
WEEK 0		5/30 MSAAD Lottery	5/31 Introduction & Site Visit Issue Exercise 1 <i>Site</i>
WEEK 1	6/4 Desk Crits	6/6 Pin-Up Exercise 1 Site Issue Exercise 2 <i>Housing</i>	6/7 Desk Crits & Discussion <i>Housing</i>
WEEK 2	6/11 Pin-Up Exercise 2 Issue Exercise 3 <i>Water Management</i>	6/13 Desk Crits & Discussion <i>Water Management</i>	6/14 Desk Crits
WEEK 3	6/18 Present Exercise 3 Issue Exercise 4 <i>Manifesto</i>	6/20 Desk Crits	6/21 Desk Crits
WEEK 4	6/25 Present Exercise 4	6/27 Desk Crits	6/28 Desk Crits
WEEK 5	7/2 MID REVIEW 2:00 pm Ware Lounge	7/4 HOLIDAY Independence Day	7/5 Desk Crits
WEEK 6	7/9 Pin-Up	7/11 Desk Crits	7/12 Desk Crits
WEEK 7	7/16 Pin-Up	7/18 Desk Crits	7/19 Desk Crits
WEEK 8	7/23 Pin-Up	7/25 Desk Crits	7/26 Desk Crits
WEEK 9	7/30 Desk Crits	8/2 Desk Crits	8/3 FINAL REVIEW 2:00 pm 115 Avery